

Article number: 04063150

Description: Stabilus Lift-O-Mat Gas Spring 063150 250N
03 08 105 0250 Eyelet/Eyelet

Measures

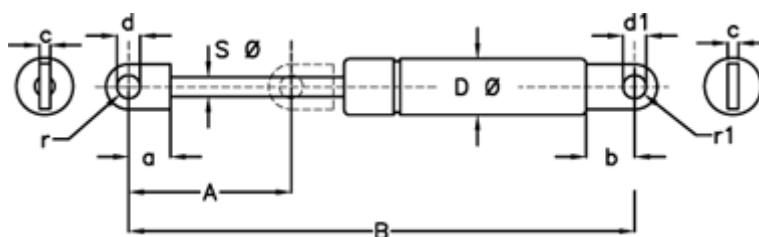

A = 105

a = 15

b = 16.5

B = 318 +/-2

c = 5

$d1^- = 8,1 +0,3$

$D^- = 19,0$

$d^- = 8,1 +0,3$

Fixing = $\varnothing je / \varnothing je$

Material = Metal

Note = -

Note = -

r = 7.5

r1 = 7.5

$S^- = 8$